

# RFID TAGS

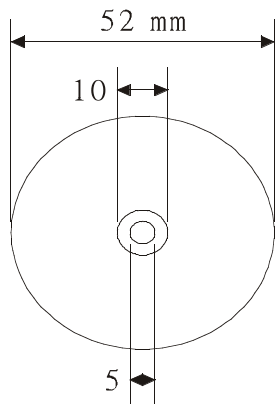

**TAG52**

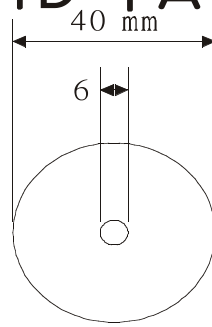

**TAG40**

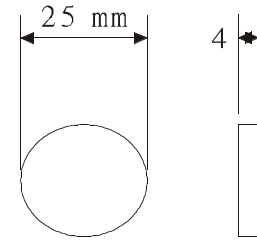

**TAG25**

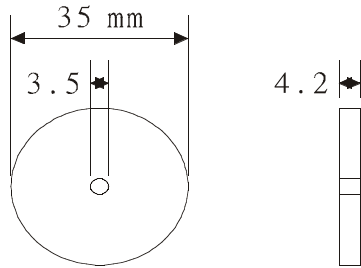

**TAG35**

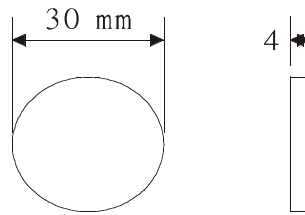

**TAG30**

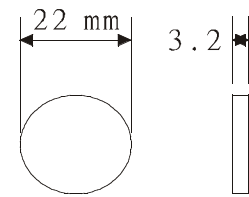

**TAG22**

## Specifications

Typical maximum read range: (Use GP30 reader)

TAG52	up to 26 cm	TAG30	up to 19 cm
TAG40	up to 24 cm	TAG25	up to 16 cm
TAG35	up to 21 cm	TAG22	up to 14 cm
TAG25K	up to 16 cm		

## Dimensions:

( as above drawings )

## Operating temperature:

-45°to 70°C

## Storage temperature:

-50°to 160°F (-45°to 70°C)

## Part number

Part NO.: TAG52, TAG40, TAG35, TAG30,  
TAG25, TAG22

Description: 125kHz, ASK, Manchester coding

Rate timing: MOD64 (64 clocks per bit)

## Options:

- Customer assigned numbers
- Number printing

## Chip type:

EM H4002 (or compatible), GiTAG1 or 2

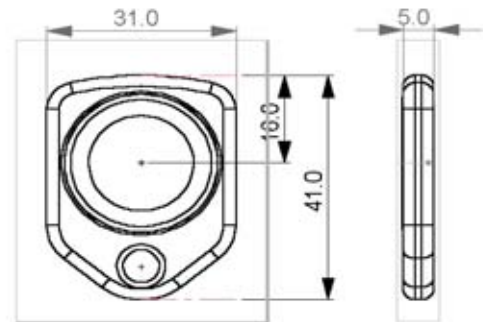

**TAG25K**

## Features

**Compatibility:** EM H4002

**Coding:** Factory preprogrammed

**Options:** Field programmable

**Passive:** No batteries required

**Security:** Customer defined unique formats (option)

**Material:** ABS, waterproof

AceProx Identifikations GmbH

Bahnhofstr. 4

31691 Helpsen

Germany

Tel.: +49-5724-98360

Fax: +49-5724-98361